

# Jumbo Wide Retractor

5': 261080, 261081, 190314  
6': 261082, 261083, 190315  
8': 261018, 261019, 190296

## Product Parts

- 1 - Base
- 2 - Banner Rail
- 3 - Shock cord Pole (x2)
- 4 - Pin

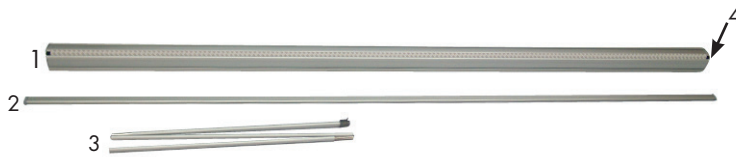

**\*Do Not Pull Pin Until Directed**

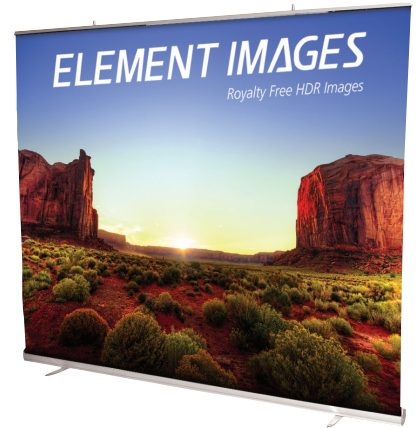

## Banner Install

### Step 1

Remove all of the product parts from the bag and place, along with the banner, on a clean flat surface. Remove both End Caps (A) from the Banner Rail and snap the Banner Rail (2) open. Fully insert the top edge of the Banner into the groove of the Banner Rail (2) and snap the rail shut (B).

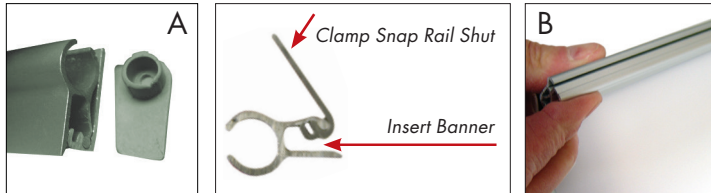

### Step 2

Lay the banner flat, printed side up. Align the bottom of the banner to the adhesive strip on your leader. Remove the protective paper from the adhesive and firmly press the bottom of the banner onto the adhesive, and be sure to smooth out any bubbles or wrinkles.

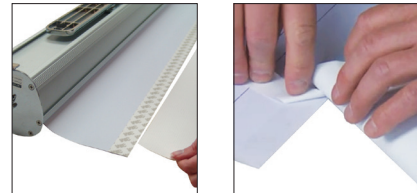

### Step 4

Maintain tension on the banner while slowly removing the Pin (4). Allow the banner to gently roll into the canister.



**\*\*Keep the Pin for future graphic changes.**

### Step 5

Once the banner has been fully retracted into the Base, simply place the display in the carrying case until you are ready for display set-up.

## Display Set-Up

### Step 1

Remove the display from the carrying case and place at your desired location



### Step 2

Flip the Base (1) upside down and rotate the feet to sit perpendicular to the Base.



### Step 3

Insert the Shock Cord Poles (3) into the receptacles on the base (1). Ensure the poles are seated completely into the bottom half circle cutout.



### Step 4

**\*\*\* To ensure that the display does not twist, it is recommended that two people extend the banner from the base and hook the snap rail to the poles.**

In tandem with another person, stand facing the back of the Base and gently pull the Banner Rail (2) upwards. Clip both Hooks into the openings located on the Poles.



## Storage

Place all product parts into Carry Case and store in a cool dry location.



## Care

To clean, wipe with damp cloth.