

MODCO 19 - 10X10

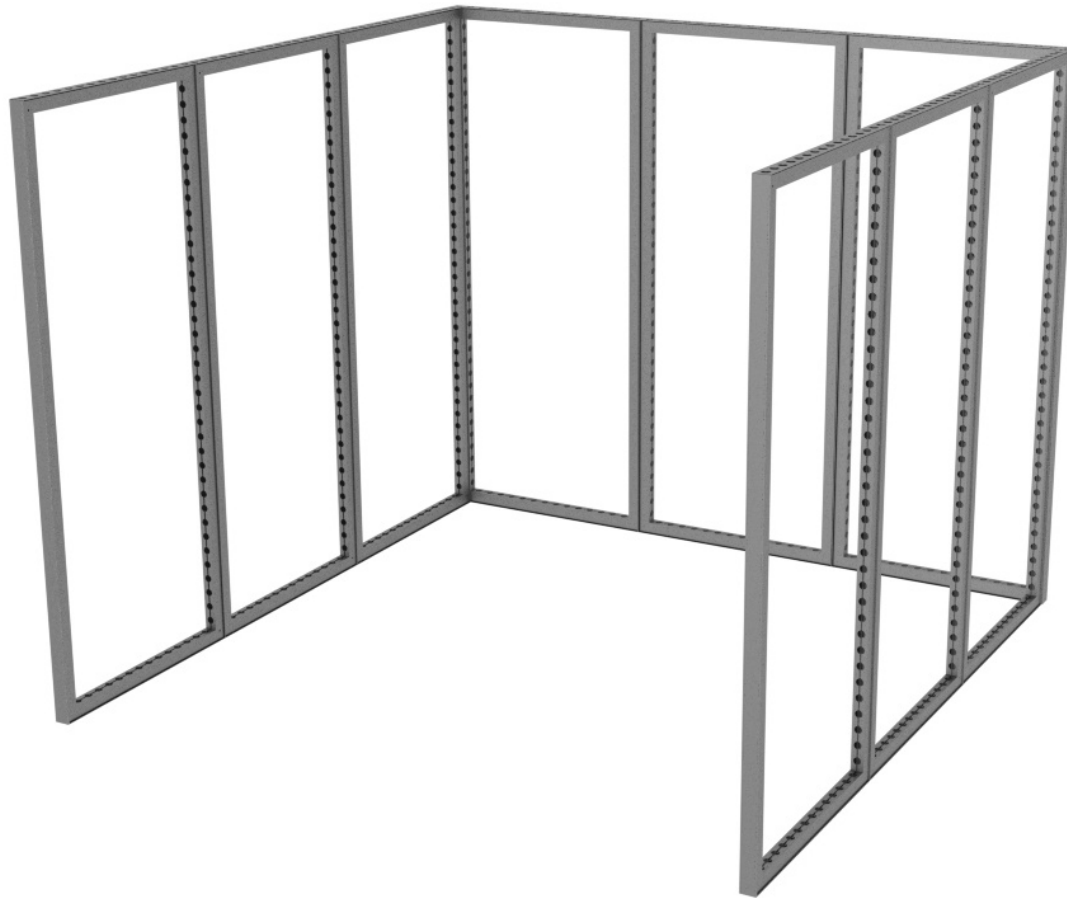

MODCO 19 - 10X10

- Use REF column to reference parts. Repeat this step until you have a total of 3 walls.

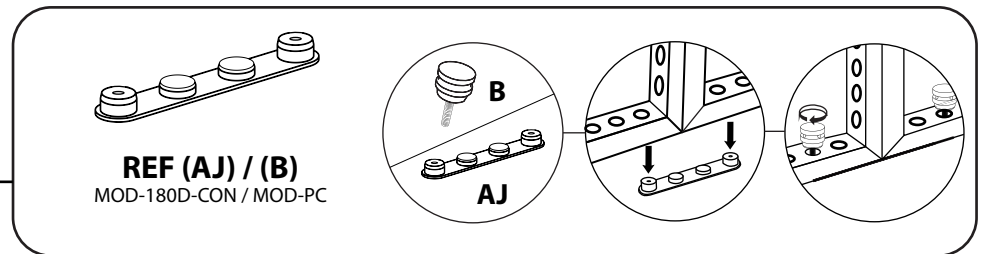
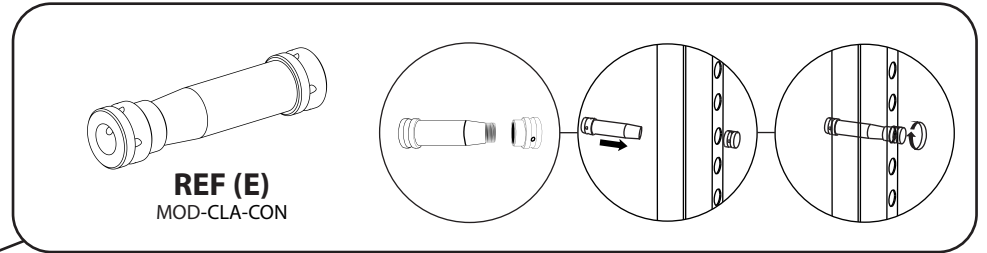
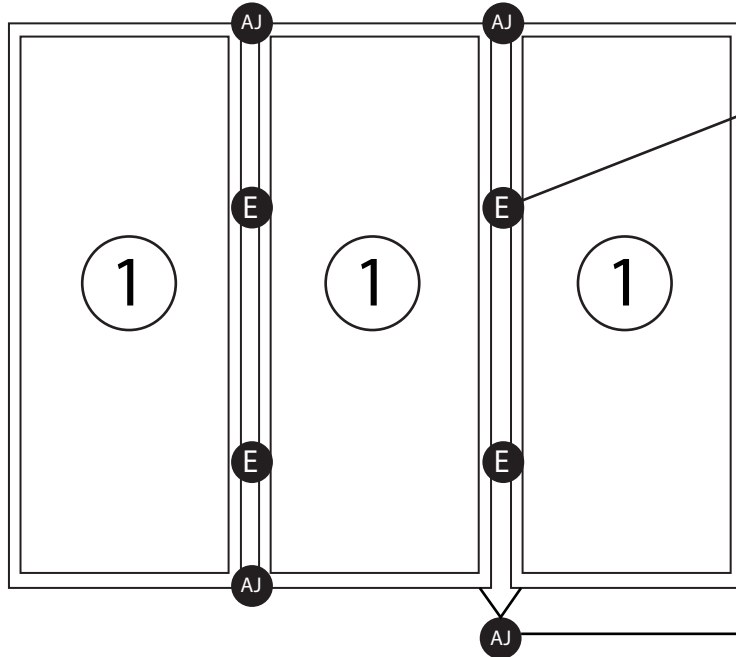

| REF | QTY | PART NO. | DESCRIPTION |
|-----|-----|------------------|---|
| 1 | 9 | MOD-FRM-992x2418 | Straight Frame, Corner Screw Connect 992mm x 2418mm |
| B | 40 | MOD-PC | Pin Connector |
| C | 4 | MOD-90D-CON | 90° Connector |
| D | 4 | MOD-SM90D-CON | 90° Connector |
| E | 12 | MOD-CLA-CON | Clamp Connector |
| AJ | 12 | MOD-180D-CON | 180 Degree Connector |

MODCO 19 - 10X10

- Use REF column to reference parts. Connect each wall to make a 90° corner. Repeat for opposite side.

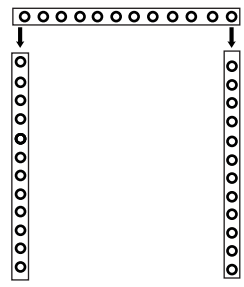
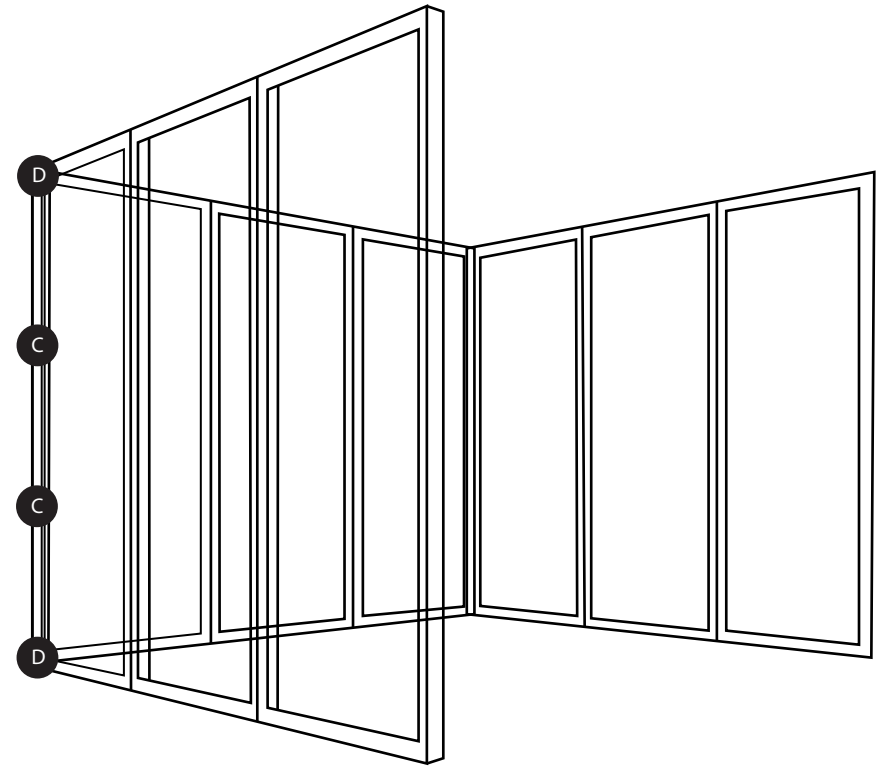
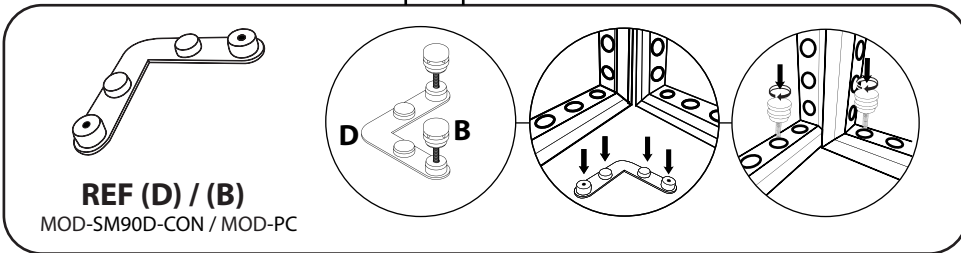
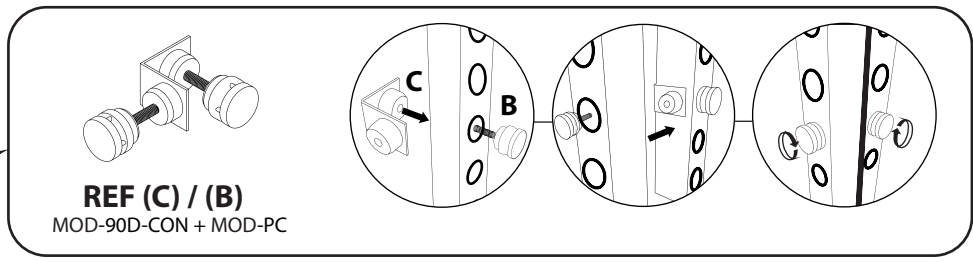
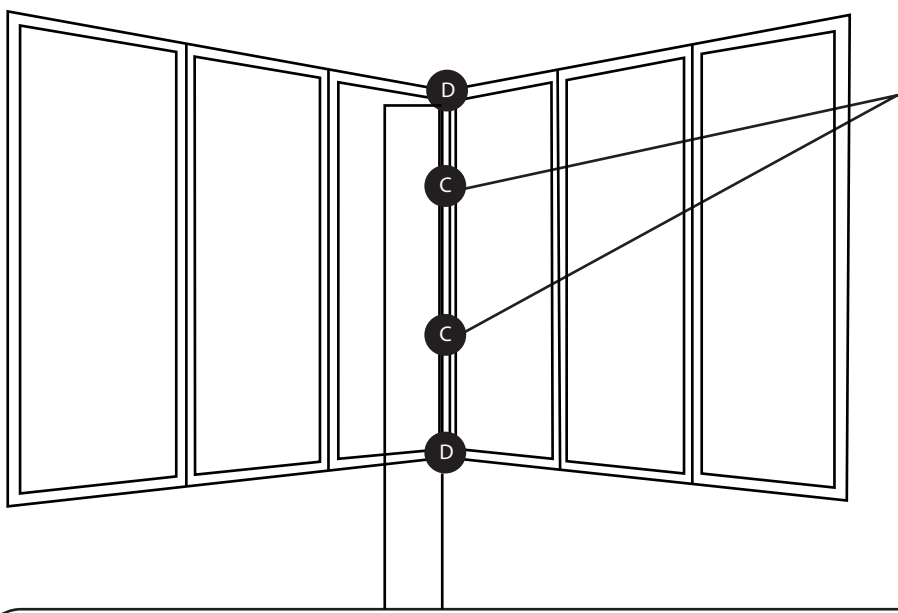

TOP VIEW OF ROOM

MODCO 19 - 10X10

- Use REF column to reference parts. Attach cover profile to each exposed side (4 sides total).

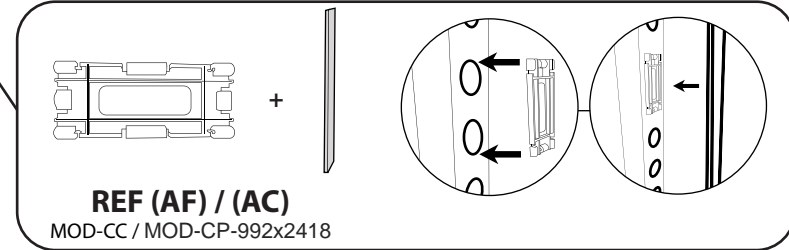
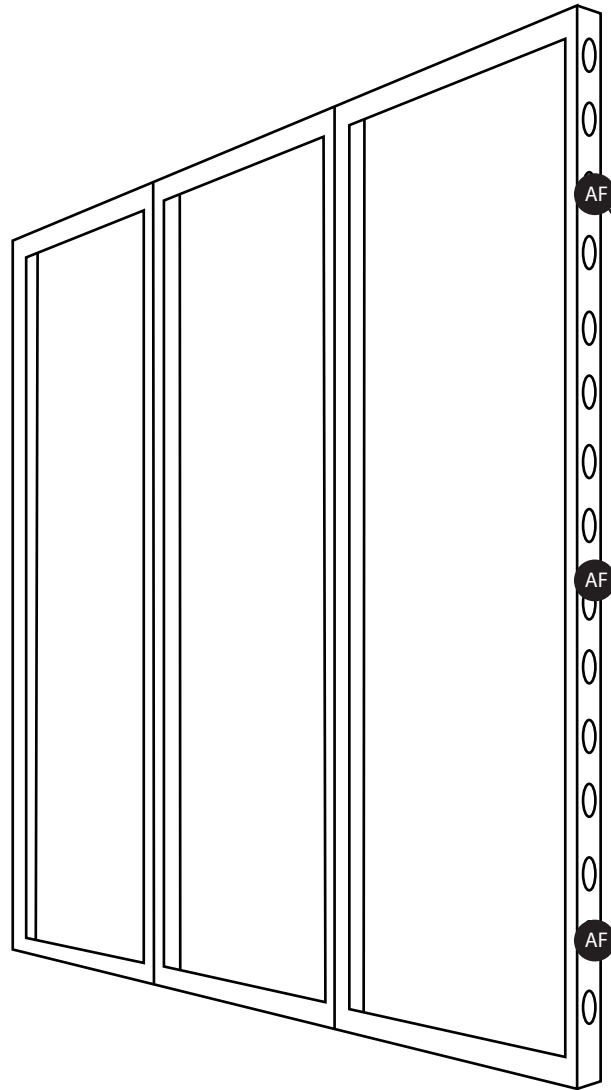

| COVER PROFILES & ACCESSORIES | | | |
|------------------------------|-----|-----------------|--|
| REF | QTY | PART NO. | DESCRIPTION |
| AC | 4 | MOD-CP-992x2418 | Cover Profile for Frame 992x2418. Flat Model. Anodized |
| AF | 12 | MOD-CC | Clip Connector Cover Connects Cover Profile |
| AL | 36 | MOD-FP | Modco Frame Protector |

GRAPHIC INSTALL



Place graphic over the front of the frame.



Begin inserting SEG beading at each corner.

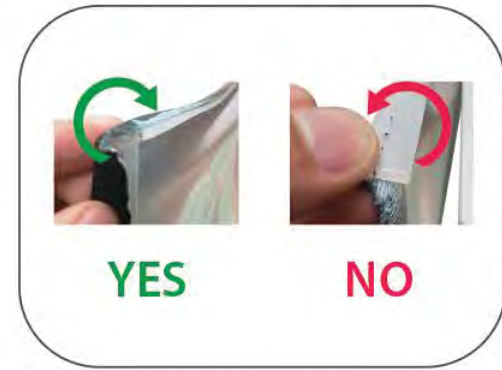

Insert the silicone beading with the fabric folded over. The silicone beading should not be exposed.

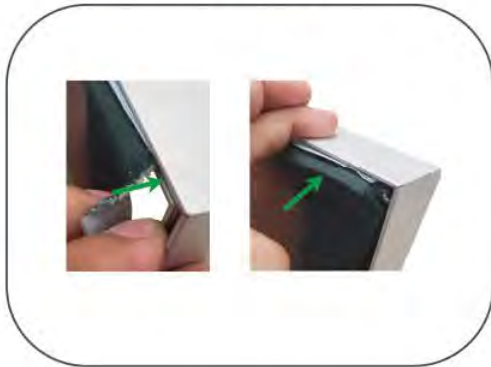

Using your fingers, push both fabric and silicone beading completely into the extrusions channel.



Continue to push in the remaining silicone beading on each side.



Check the perimeter of the frame for any excess beading that hasn't been pushed in. Graphic should be taut.